



South Pointe

 TEMPLE, TX 76504**Sales Center Location:**1932 Delano Drive
Temple, TX 76504**Community Contact:**Ady
254-284-5520**Price Range:**

\$239,400 - \$333,400

Sq.Ft. Range:



1,266 - 2,583

Featuring the best in affordable luxury, Stylecraft at South Pointe offers the ideal location for investors, growing families, doctors in residency, Veterans, students, and more. Just up the road from Baylor Scott & White Medical Center, the VA Medical Center, Temple College, and more. Homeowners enjoy access to several retail shopping outlets including Temple Mall, Walmart Super Center, Sam's Club, H-E-B, and Lowe's Home Improvement, while also enjoying the privacy offered by the country-like atmosphere.

For family entertainment, stop by the IMAX Theater or cool off at the Summer Fun Water Park while sliding down a 900 ft water slide! Fancy yourself a sommelier? Then stop by the two nearby, newly opened wineries to showcase your skills. During the holidays, head over to the Robinson Family Farm to pick your prize pumpkin or live Christmas tree. There is always plenty to do for kids and adults alike!

Come home to MORE with a home that includes granite countertops throughout, luxury vinyl plank flooring, stunning tile selections, show-stopping facades, and an unmatched level of customer service and signature style.



	All
	Available Homes
	Sold Homes

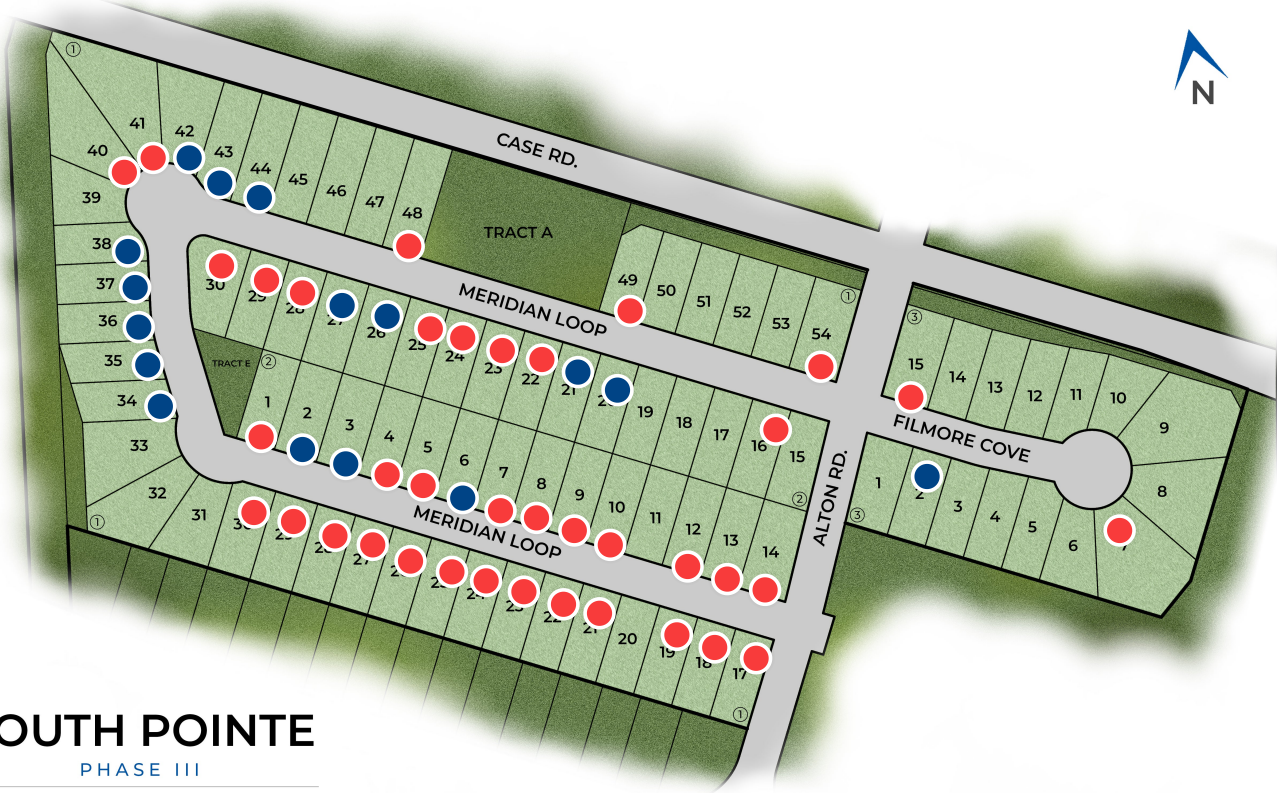

SOUTH POINTE

PHASE III

TEMPLE, TX

Trees are for artistic purposes and do not fully reflect current conditions and/or developers intentions



READY EARLY 2025



**2012 Meridian Loop Temple, TX
76504 | Single Family**

\$245,400

 1,266 Ft²

 3 Bed

 2 Bath

 2 Car Garage

READY EARLY 2025



**1964 Meridian Loop Temple, TX
76504 | Single Family**

\$249,200

 1,354 Ft²

 3 Bed

 2 Bath

 2 Car Garage

READY FALL 2024



**2024 Meridian Loop Temple, TX
76504 | Single Family**

\$252,100

 1,354 Ft²

 3 Bed

 2 Bath

 2 Car Garage

READY FALL 2024



**2117 Meridian Loop Temple, TX
76504 | Single Family**

\$252,800

 1,354 Ft²

 3 Bed

 2 Bath

 2 Car Garage

READY FALL 2024



**2129 Meridian Loop Temple, TX
76504 | Single Family**

\$262,800

 1,448 Ft²

 3 Bed

 2 Bath

 2 Car Garage

READY FALL 2024



**1927 Meridian Loop Temple, TX
76504 | Single Family**

\$264,300

 1,517 Ft²

 3 Bed

 2 Bath

 2 Car Garage



READY SPRING 2025

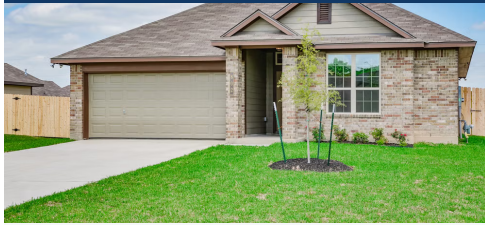

**2007 Filmore Cove Temple, TX
76504 | Single Family**

\$264,500

1,517 Ft²

3 Bed

2 Bath

2 Car Garage

READY FALL 2024



**1953 Meridian Loop Temple, TX
76504 | Single Family**

\$265,900

1,517 Ft²

3 Bed

2 Bath

2 Car Garage

READY SPRING 2025



**1968 Meridian Loop Temple, TX
76504 | Single Family**

\$269,700

1,620 Ft²

3 Bed

2 Bath

2 Car Garage

READY EARLY 2025



**2020 Meridian Loop Temple, TX
76504 | Single Family**

\$271,300

1,620 Ft²

3 Bed

2 Bath

2 Car Garage

READY FALL 2024

**1947 Meridian Loop Temple, TX
76504 | Single Family**

\$273,500

1,620 Ft²

3 Bed

2 Bath

2 Car Garage

READY FALL 2024

**1923 Meridian Loop Temple, TX
76504 | Single Family**

\$274,100

1,666 Ft²

4 Bed

2 Bath

2 Car Garage

READY LATE 2024

READY FALL 2024



READY EARLY 2025

**READY LATE 2024****2028 Meridian Loop Temple, TX
76504** | Single Family

\$274,500

 1,666 Ft² 4 Bed 2 Bath 2 Car Garage**READY FALL 2024****2113 Meridian Loop Temple, TX
76504** | Single Family

\$283,100

 1,620 Ft² 3 Bed 2 Bath 2 Car Garage**READY EARLY 2025****1972 Meridian Loop Temple, TX
76504** | Single Family

\$294,900

 2,041 Ft² 4 Bed 3 Bath 3 Car Garage**READY EARLY 2025****2016 Meridian Loop Temple, TX
76504** | Single Family

\$297,200

 2,041 Ft² 4 Bed 3 Bath 3 Car Garage